

FINDING YOUR WAY AT GV HEALTH  
GRAHAM STREET, SHEPPARTON CAMPUS  
Level 1 & Directory on Reverse

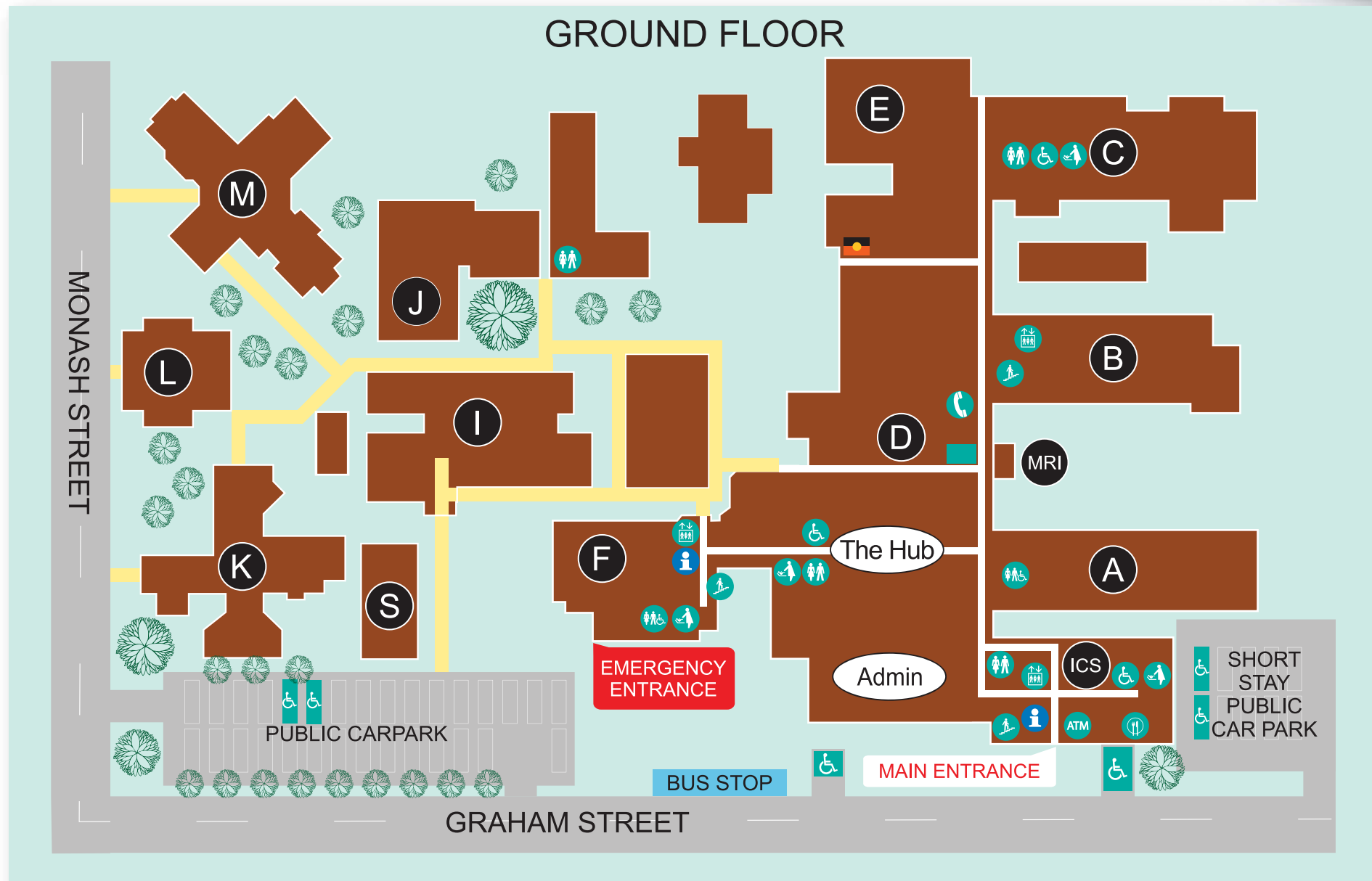

## GRAHAM STREET, SHEPPARTON CAMPUS

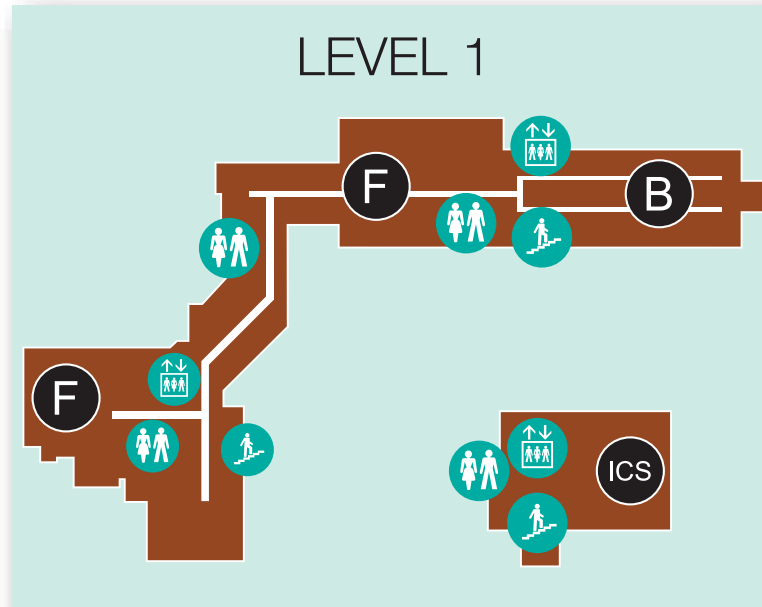

### DIRECTORY

- Information
- Toilets
- Baby Change
- Disabled Toilets
- Disabled Access
- Lifts
- Stairs
- Cafe
- Public Telephone
- Automatic Teller Machine

#### Admin

- Administration
- Boardroom
- Cashier
- Community Therapies Room
- Executive Offices
- Finance
- Human Resources

#### The Hub

- Admissions - Elective
- Ante-natal
- Audiology
- Medical Imaging
  - X-ray
- Pharmacy
- Pre-Admissions

- A** Allied Health
  - Cardiac Rehabilitation
  - Nutrition and Dietetics
  - Occupational Therapy
  - Physiotherapy
  - Social Work
  - Specialist Drug and Alcohol Clinic
  - Speech Therapy
 Community Health  
 Community Rehabilitation Centre
- B** **Ground Floor**
  - GV Health Foundation
  - Rehabilitation and Geriatric Evaluation and Management: Mary Coram Unit**Level 1**
  - Intensive Care Unit
  - Medical Day Unit/Discharge Lounge
  - Medical Ward
  - Operating Suite
- C** Child and Adolescent Unit
  - Child and Youth Mental Health Services
  - Paediatric Outpatients
  - Paediatric Rehabilitation Service
  - Victorian Infant Hearing Screening
- D** Dining Room
  - Medical Imaging
    - CT Scan
    - Electrodiagnostic Unit
    - Nuclear Medicine
    - Ultrasound
  - The Sanctuary
- E**
  - Aboriginal Liaison Officers
  - Minya Barmah room
  - GV Health Supplies Shop
  - Supply Department
- F** **Ground Floor**
  - Emergency Department
  - Haemodialysis**Level 1**
  - Birth Suite
- F** **Level 1 continued**
  - Day Procedure Unit
  - Maternity Ward
  - Neo-natal Nursery
  - Operating Theatre
  - Surgical Ward
- I** Clinical Skills Laboratory  
Library  
Specialist Consulting Suites
- J** Elsie Jones Education Centre
- ICS** **Ground Floor**
  - Glasshouse Cafe
  - Integrated Care Services (ICS)
    - Chronic Pain Service
    - Cognitive Dementia and Memory Clinic
    - Continence Clinic
    - Diabetes Centre
    - Falls and Mobility Clinic
    - Movement Disorder Clinic
    - Podiatry
  - Main Reception**Level 1**
  - Dental
- K** Mental Health Services
  - Wanyarra Acute In-Patient Unit
  - Aged Acute In-Patient Unit
- L** Administration; Community Mental Health
- M** Mental Health
  - Grutzner House
  - Rosewood
- S** Oncology: Peter Copulos Cancer and Wellness Centre  
Pathology Collection



Telephone: (03) 5832 2322  
Graham Street, Shepparton

